



# Classic

In a Class of Their Own

For Winch 101  
511011



For Winch 91  
510911



Classic ANDERSEN Winches® are fitted worldwide as standard on Dragon, H-boats, Folkboats among many others. These winches have become a legend in their class, and can be used on any yacht of up to 2 tons' displacement.

Classic ANDERSEN Winches — except for model 28STU — have one gear and can be operated as either a bottom-action winch or an under-deck version with various shaft lengths. Please refer to table to make the correct choice.

A feature of the classic single-speed winch is that the handle can be pumped. On this type of winch, the handle is included in the price — except for an model 28STU. What's more all handles can be purchased separately.

The ANDERSEN Classic Range® also offers a choice of under-deck self-tailing winches, particularly suitable for yachts with open cockpits.



# Winches

## Classic Winches

Winch Model	Drum "D" [mm]	Base "B" [mm]	Height "H" [mm]	Line entry "L" [mm]	Line size [mm]	Weight [kg]	Gear Ratio 1 <sup>st</sup> speed	Gear Ratio 2 <sup>nd</sup> speed	Power Ratio 1 <sup>st</sup> speed	Power Ratio 2 <sup>nd</sup> speed	Max dept "J" [mm]	Handle lenght "S" [mm]	Handle lenght "R" [mm]	Art. No.
12 ST U	70	115	132	44	8 - 14	4.2	1.3:1	n/a	9.5:1	n/a	150	254	n/a	500215
28 ST U	70	125	159	65	8 - 14	6.1	1.3:1	3.7:1	9.5:1	26.5:1	150	254	n/a	500229
91	51	80	94	n/a	n/a	1.0	1.0:1	n/a	8.0:1	n/a	n/a	n/a	203	510091
101	83	111	89	n/a	n/a	1.5	1.0:1	n/a	5.5:1	n/a	n/a	n/a	254	510101
102	83	111	74	n/a	n/a	2.0	1.0:1	n/a	5.5:1	n/a	150	240	n/a	510102
102	83	111	74	n/a	n/a	2.1	1.0:1	n/a	5.5:1	n/a	200	240	n/a	510103
102	83	111	74	n/a	n/a	1.9	1.0:1	n/a	5.5:1	n/a	100	240	n/a	510105

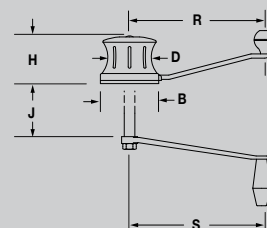

When investing in quality at sea, you are investing on multiple levels — and with the joy of multi-level returns on your investment. Safety at sea is always a result of sound investments in the right equipment. Therefore, if your equipment grows with your needs and skills — as it can with ANDERSEN Products® — you can rest assured that your investment is safe.